

# Doping Control Station

## 1. Facilities

Each venue where an IIHF competition is played and Doping Control is carried out shall have adequate rooms to be used for the Doping Control Station. The Doping Control Station shall be secured and lockable and include **both a separate waiting room and a Doping Control Station Office** and within the vicinity of the player locker rooms.

Facilities should meet the following criteria for in-competition testing:

- Reserved only for doping control purposes
- Accessible only to authorized personnel
- Provision of security staff for each Doping Control Station to employ during sample collection procedures.
- Possibility to lock the doors, in order to store samples and equipment
- Private enough to ensure athletes' privacy and confidentiality
- Ideally per each Doping Control station
  - 2 rooms + toilet(s) including
  - Processing room
  - Waiting area
  - Toilet
- Large enough to accommodate the number of athletes to be tested, athlete representatives and sample collection personnel
- Located within a reasonable distance to the competition venue
- Facilities to wash hands prior to the provision of a urine sample

The rooms shall be equipped with the following items:

### Doping Control Station

- One table and a chair for the DCO processing documentation – serving as the “office”
- Internet connection, laptop and fax
- Lockable cabinet for the doping control equipment, forms and files
- One table and 4 chairs for the sample collection procedure
- Separate toilet equipped with mirrors which is big enough for the player and a witness being inside at same time during the sample given procedure
- A bed for blood sample collection
- Lockable fridge to store samples and adequate temperature (0°C)
- Appropriate lighting to conduct processing
- Security person outside doping control station

### Waiting Room

- Space for 10-12 people inside at the same time
- 4-6 chairs or sofa
- Refrigerator for sealed non-alcoholic drinks
- Security person outside the room (if the waiting room is separate from the DCS)

The Organizing Committee shall ensure that the hallway floor from the rink surface to the Doping Control Station is covered with rubber matting.

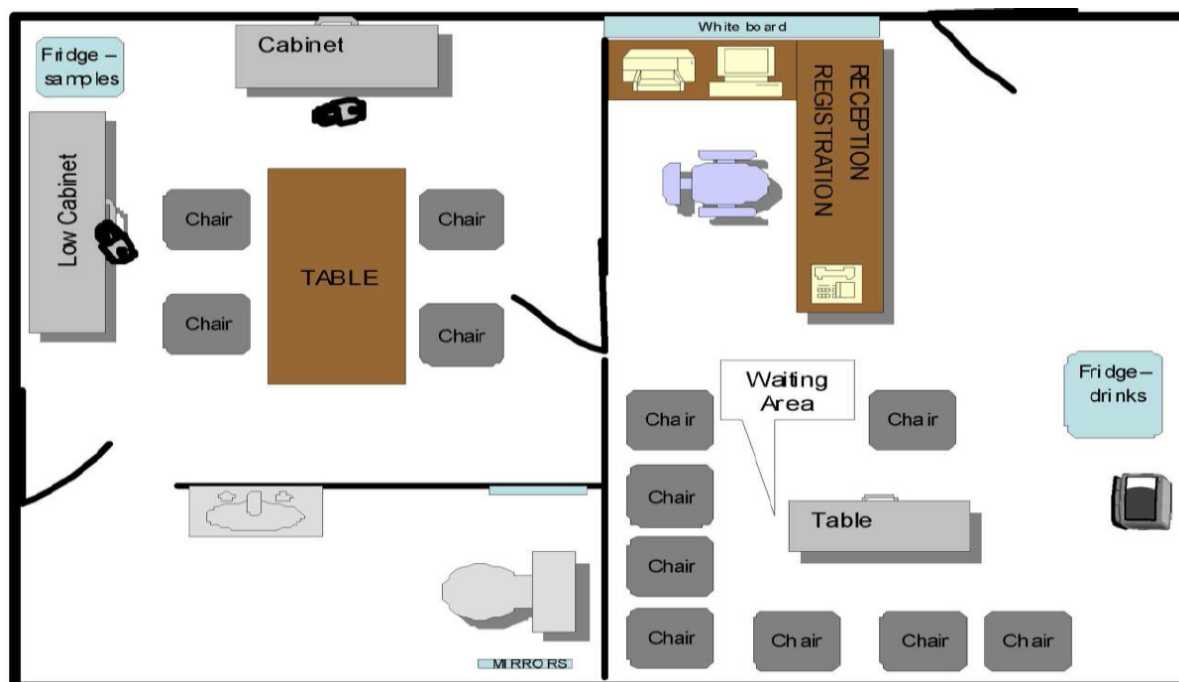

Example of a DCS-set up

## 2. Personnel

The Doping Control Officer is a well-trained person from either a third-party provider or the NADO. The DCO shall be accredited and have full and unlimited access to all facilities.

## 3. Chaperones

For each game the LOC must provide the Doping Control Officers with the same number of chaperones and of the same gender as the players tested.

All Chaperones must meet the following criteria:

- Must be 18 years of age or older
- Must have the ability to communicate effectively in English
- Must not have any perceived or actual conflict of interest with the sport and/or athletes who are involved in this sport at the:
  - Participation level (i.e. competitor, coach, referee, official);
  - Organizational level (i.e. provincial, national, international); and/or
  - Personal/professional level (i.e. relative, friend, acquaintance, client).

Chaperones are responsible for notifying, accompanying and observing the selected athletes from their notification until they report to the doping control station, as well as for the supervision of the athletes in and outside the doping control station.

The individuals selected to work as chaperones must have abilities to follow procedures, directions and instructions, to work in stressful situations.

Chaperones should be exclusively available for their duty throughout the testing session and will be trained by the DCO before the competition starts.

## 4. Laboratories

Only WADA accredited laboratories are used for the doping control analysis.

## 5. Equipment

Equipment will be brought in by the Service Provider or the NADO. The Local Organizing Committee shall ensure that the equipment can be stored in a lockable cabinet.

We would also suggest that your national association consult our IIHF Medical Care Guide, which you will find on our web site under the following web-address: <http://www.iihf.com/iihf-home/sport/medical.html> to set up your medical service for the championship.